



Conservation
ONTARIO
Natural Champions

Application Form For Development Including Placing of Fill, Construction, Interference to Wetlands and Alteration to Shorelines and Watercourses

Rideau Valley Conservation Authority, Ontario Regulation 174/06
3889 Rideau Valley Drive, P.O. Box 599, Manotick, ON K4M 1A5

Section 28 (1) of the CA Act states that, subject to the approval of the Minister, an authority may make regulations applicable in the area under its jurisdiction, (b) prohibiting, regulating or requiring the permission of the authority for straightening, changing, diverting or interfering in any way with the existing channel of a river, creek, stream or watercourse, or for changing or interfering in any way with a wetland or (c) prohibiting, regulating or requiring the permission of the Authority for development if, in the opinion of the authority, the control of flooding, erosion, dynamic beaches or pollution or the conservation of land may be affected by the development. The information on this form is required in order to consider the granting of permission under the Regulation.
Only complete applications can be processed (please see 'complete application' guide).

Landowner Name	Telephone No.	Fax. No.
Mailing Address	Business No.	
	e-mail	
Postal Code	Agent's Name:	
	Phone:	Fax. No.

Application is hereby made to:

- Place or Remove Fill
- Construct New Building
- Add, Alter or Renovate Building
- Install Sewage Disposal System
- Alter a Watercourse

- Interference with wetlands or other adjacent lands (within 120 m)
- Construct retaining wall, erosion control
- Construct Pond, Reservoir
- Road Crossing
- Other (Specify):

Purpose of work: (or use covering letter)

.....
.....

Description of work: (or use covering letter)

.....
.....

Location at which development or waterway alteration is proposed:

Lot: Reg. Lot No.: Current Municipality:

Concession: Reg. Plan No.: Municipal Address (St./Rd./Ave./Cr. etc.):

Former Municipality:

Existing Use of Land: (vacant, residential, etc.)

Proposed Use of Land:

Proposed Start Date: / /
 m d y

Proposed Finish Date: / /
 m d y

Signature of Owner/Authorized Agent:

(If agent, provide letter of authorization from owner))

Entry on Property

S. 28 (20) An officer appointed by the Authority may enter on private property, other than a dwelling or building, if the entry is for the purpose of considering a request related to the property for permission under application.

Attach Required Plans and Fee — including a copy of the property survey and/or deed

Personal Information contained on this form is collected under the authority of regulations made under Section 28 of the *Conservation Authorities Act of Ontario* as amended and may be shared with departments or agencies of local, provincial or the federal government having an interest in the same. Questions about this collection should be directed to the Conservation Authority.

Office Use Only

Date received: / / m d y	FHA File #:	Fee Paid: / / m d y
Circulation to: / / m d y	Application#:	Permit Issued / / m d y
Easement Ag. required:	Hearing / / m d y	Decision
	Appeal	

Required Plans Include:

A signed application form permission to construct or reconstruct or modify or add to a building or structure shall include,

- (a) 4 copies of a plan of the property showing the proposed location of the building or structure, its elevation and the proposed final grade plan;
- (b) 4 copies of a complete description of the type of building or structure to be constructed, including drainage details;
- (c) 4 copies of a statement of the dates between which the construction will be carried out; and
- (d) 4 copies of a statement of the proposed use of the building or structure following completion of the construction.

A signed application for permission to undertake site grading or place or dump fill shall include,

- (a) 4 copies of a plan of the property on which the fill is to be placed, showing the proposed location of filling, the depth to which it is proposed to fill and the proposed final grade of the land when filling is completed;
- (b) 4 copies of a complete description of the type of fill proposed to be place or dumped;
- (c) 4 copies of a statement of the dates between which the placing or dumping will be carried out; and
- (d) 4 copies of a statement of the proposed use of the land following completion of placing or dumping.

A signed application for permission to straighten, change, divert or interfere in any way with the existing channel of a river, creek, stream or watercourse, shall include,

- (a) 4 copies of a plan on which shall be shown in plan view and cross section the details of such straightening, change, diversion or interference;
- (b) 4 copies of a description of the protective measures to be undertaken;
- (c) 4 copies of a statement of the dates between which the straightening, changing, diverting or interfering will be carried out; and
- (d) 4 copies of a statement of the purposed of the proposed work.
- (e) all drawings shall be to scale.

Note: The Authority may, at any time, withdraw any permission given under this Regulation, if, in the opinion of the Authority, the conditions of the permit are not complied with.

The Conservation Authority is also authorized to include in our review consideration for whether any harmful alteration, destruction or disturbance of fish habitat will occur which would contravene the provisions of Section 35 of the *Canada Fisheries Act*. It should be noted that, where impacts can not be mitigated, *only* the Minister of Fisheries and Oceans Canada may authorize such alteration, destruction or disturbance.

Construction Drawings

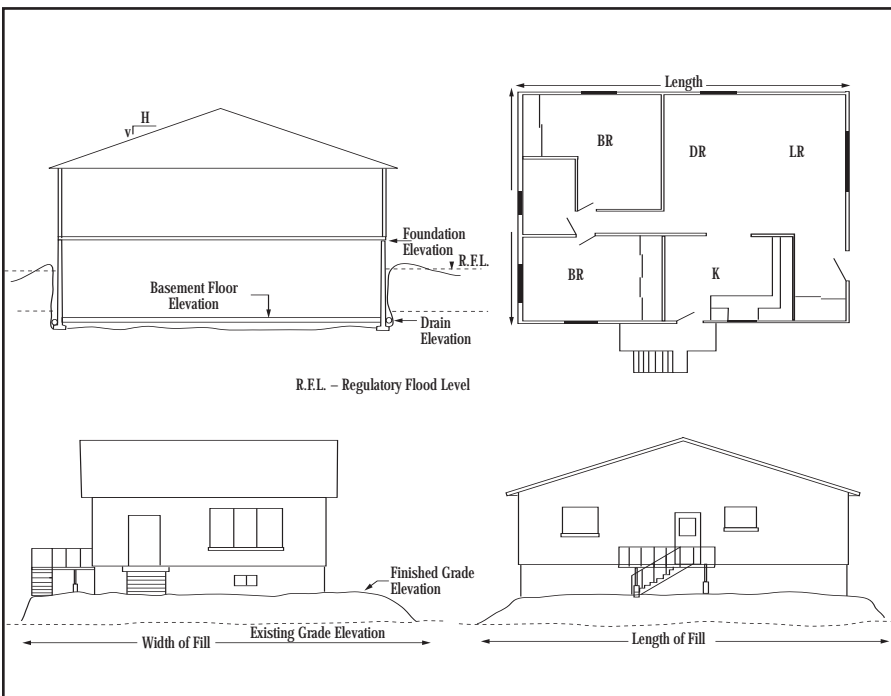

Site Plan (draw to scale or give accurate distance measurements)

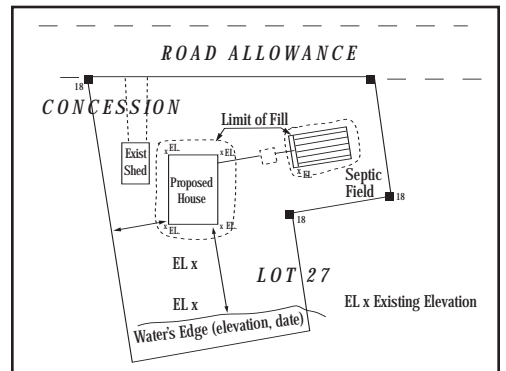

Location Plan (draw to scale or give accurate distance measurements)

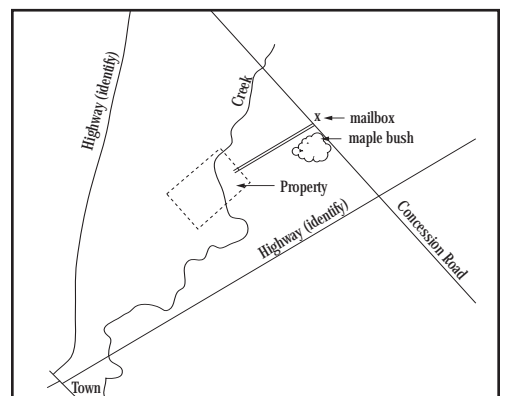

Channelization, Bank Stabilization, Erosion Control

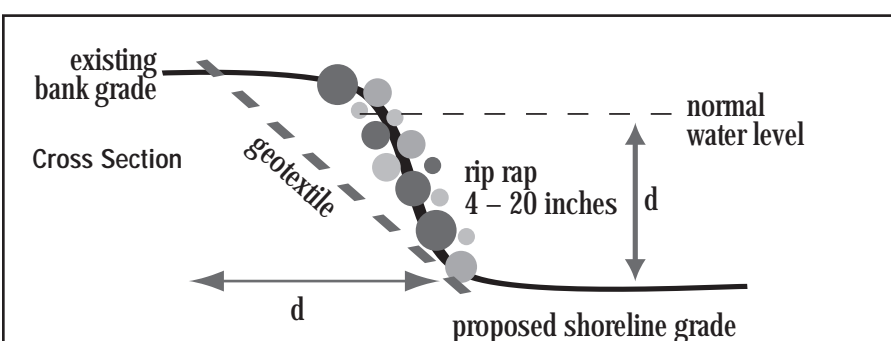
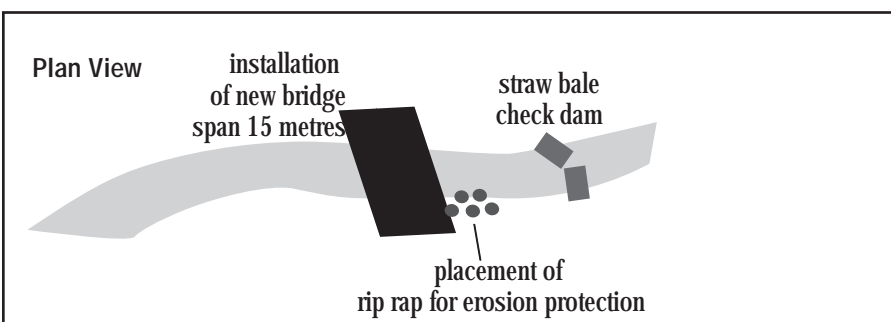

These drawings are not for design purposes; they are examples to illustrate the minimum level of detail required to enable Conservation Authority staff to process the application. Please ensure that your application is complete (as per *Ontario Regulation 97/04* — copies available) so that there will be no delay in the review process.

It is an offence to contravene any regulation made under Section 28 of the *Conservation Authorities Act* (R.S.O. 1990) and on summary conviction the accused is liable to a fine of not more than \$10,000.00 or to a term of imprisonment of not more than three months (S.28 (16)). An order may also be issued for removal of the offending structure or material (S. 28 (17) (18) (19)). Property owners and contractors can both be held accountable.