

RIDEAU VALLEY CONSERVATION AUTHORITY WATERSHED BRIEFS

June 2011

A newsletter for municipal councillors

2011 Board of Directors

Andy Jozefowicz *Athens*

Lee Armstrong *Augusta*

John Campbell *Beckwith*

Tom Dewey *Central Frontenac*

No appointment *Clarence-Rockland*

Ray Scissons *Drummond/North Elmsley*

Lyle Pederson *Elizabethtown-Kitley*

Jim Anderton *Merrickville-Wolford*

Vince Carroll *Montague*

Gerry Boyce *North Dundas*

Barclay Cormack *North Grenville*

David Crowley *Perth*

Rob Dunfield *Rideau Lakes*

Ken Graham, RVCA Vice-Chair

Smiths Falls

Gary Davison *South Frontenac*

John H. Miller *Tay Valley*

Bradley Wing *Westport*

City of Ottawa

Alan Arbuckle, RVCA Chair

David Chernushenko

Steve Desroches

Ed Hand

two vacant seats

Otter Lake Regulatory Flood Level

Staff have just completed a technical study to determine the regulatory flood level on Otter Lake. Field surveys, mapping and modeling tools were used to establish the level. This information will be used by RVCA staff as they evaluate and approve development or site alteration proposals on the shorelines of Otter Lake (ferdous.ahmed@rvca.ca).

Kemptville Creek Flood Mapping Revisions

In response to local concerns, the RVCA has revised the 1:100 year flood plain mapping for Kemptville Creek. Concerns were raised regarding specific sections of the mapping. Staff visited the area, surveyed culverts and road profiles, reviewed and refined the hydraulic calculations and modeling. Flood lines have been redrawn to reflect the updated information (ferdous.ahmed@rvca.ca).

The RVCA produces maps for our member municipalities, septic offices and interested landowners. The maps show the extent of hazard land on properties and are used in the day-to-day regulatory, plan review and conservation work of the RVCA and watershed municipalities.

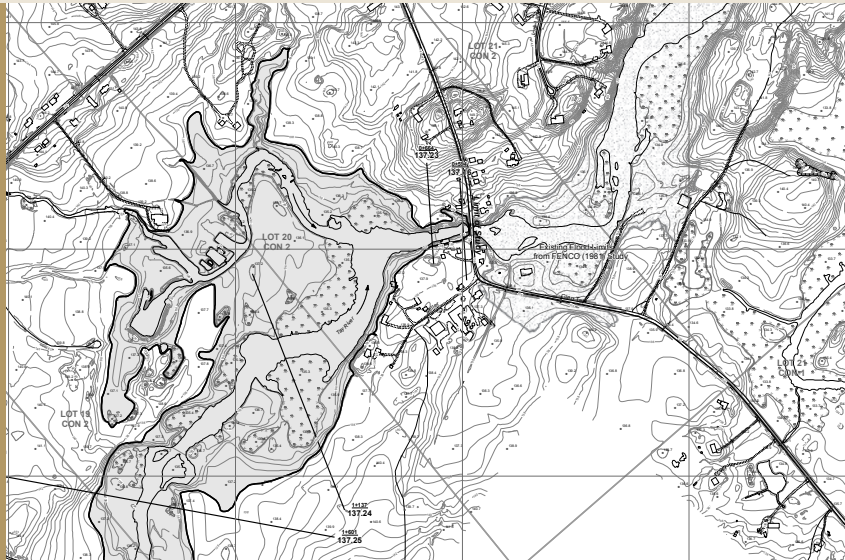

Carry In, Carry Out

The RVCA's *Carry In, Carry Out* program continues at two local conservation areas. The program is being used at Chapman Mills Conservation Area and Richmond Conservation Area to encourage everyone to "carry out" any garbage they bring into our areas during their visit. By working together, we maintain cleaner parks, avoid nasty smells and messes, reduce the number of bees and wasps in our picnic areas, allow for recycling at home and it also redirects RVCA staff time to other important park improvements (kristy.giles@rvca.ca).

Board of Director's Meetings

Thursday, August 25, 2011
Location to be announced

**Now Available online
@ www.rvca.ca
under "What's New:"**

- Otter Lake Regulatory Flood Level Report
- 2010 Jock River Subwatershed Report
- Solutions for Shoreline Erosion — A Basic Guide to Bioengineering
- RVCF Memorial Tree Planting in the Rideau Valley
- City Stream Watch 2010 Annual Report

Follow us @
[Twitter.com](https://twitter.com/rvca)

Like us @
[Facebook.com](https://www.facebook.com/rvca)

✉ Box 599
3889 Rideau Valley Dr.
Manotick ON
K4M 1A5

☎ 613 692 3571
800 267 3504

☎ 613 692 0831

✉ postmaster@rvca.ca

🌐 www.rvca.ca

Haggart Island Dams Reconstruction Project

Built in 1971, the two Haggart Island Dams are in need of repair. The existing gabion and timber construction is failing and needs to be replaced with reinforced concrete structures. Decommissioning the two dams was considered, but reports show that the dams support the high quality of upstream aquatic habitat and wetlands on the Tay River and Grants Creek.

Aqafor Beech Ltd., in association with Morrison Hershfield and Schollen & Co. Ltd., has been hired to undertake Phase One of this two phase project. Phase One includes the design of both dams and reconstruction efforts for the dam located at the Rainbow Bridge. Funding for this work is in place through the RVCA, Town of Perth and Ontario Ministry of Natural Resources through the Water and Erosion Control Infrastructure (WCI) Program. Phase Two is the restoration of the second dam and will only be undertaken once funding is secured. Construction of the first dam should begin in the summer of 2012 (bruce.reid@rvca.ca).

Jock River Subwatershed Report

This information-loaded report summarizes the health of the Jock River Subwatershed by looking at four indicators — forest cover, wetlands, shoreline vegetation and surface water quality. Residents and municipalities in the area now have a reliable set of baseline information for tracking future trends and for targeting stewardship activities. The Jock River Subwatershed Report is part of the RVCA's watershed management mission that recognizes the connections between local awareness, local concern and local action as we work for environmental protection, preservation and enhancement. This information is used for decision-making at all levels (individual, family, municipal, county, provincial). These monitoring efforts help us better understand watershed trends and help focus resource management actions where they are needed the most. Download your copy at www.rvca.ca under "What's New" (martin.czarski@rvca.ca).

Bad Weather Shoreline Damage

Recent windstorms have caused erosion and damage to shoreline structures, particularly in the upper reaches (cottage country) of the Rideau Watershed. Some of the remedies for the damage may need more than just a minor "tweak." A reminder to all municipalities that their residents should check with their local Conservation Authority to see if a permit is required prior to doing any "clean-up" work along shorelines (e.g., shoreline stabilization or repair to shore works, erosion control, dock construction). There are also restrictions to when you can undertake in-water work, such as crib repair. Give the RVCA's Landowner Resource Centre a call to see if there are any restrictions or approval requirements at 613-692-3571 or 1-800-267-3504 ext. 1128 or ext. 1132. There may be grants available to help with shoreline stewardship activities.

Have you Considered Going Carbon Neutral?

RVCA has a small, cost-effective tree planting service that can be used to help offset the carbon emissions from municipal conferences, vehicle fleets, special events or even as staff recognition programs. Planting trees is one of the best things anyone can do for the environment. Aside from absorbing carbon dioxide from the atmosphere, trees reduce soil erosion, enhance local climates, improve the soil and help keep our water clean and provide wildlife habitat. Get your next municipal event off on the right environmental foot and make your municipality one of the greenest in the valley (charles.billington@rvca.ca or dan.cooper@rvca.ca)

Did you know the RVCA . . .

- ... **takes over 1,780 samples on 39 lakes through the RVCA's Watershed Watch Program?** That adds up to over 5,080 samples taken since 2001.
- ... **takes over 390 water quality samples from 56 sites as part of the RVCA's Baseline Stream Water Quality Program?**
- ... **takes over 320 samples from 10 sites across the watershed as part of the Provincial Water Quality Monitoring program?** That adds up to 124,563 pieces of data collected since 1966.

